

# WATT TIEDER HOFFAR & FITZGERALD

McLean, VA  
Relocation

## Size

33,000 square feet

## Project Highlights

Relocation to new, bright space with room for future growth; Focus on public spaces for collaboration and lounging; Large, divisible conference room; Open staircase with featured routed wood panel; Universal offices with glass-fronts redefine hierarchy and transparency; Team rooms replace typical corner offices; Admin stations create bright, library-like space for collaboration

## Services Provided

Full service interior design and architecture; Building evaluation and selection services; Lighting design

## Metrics

36 Universal Attorney Offices  
7 Corporate Offices  
9 Admin Assistant Workstations  
1:4 Admin to Attorney Ratio  
916 USF/Attorney  
630 USF/Staff  
9 Enclosed Touchdown Areas  
(8 for Future Growth Offices)  
12 Flexible Case Rooms



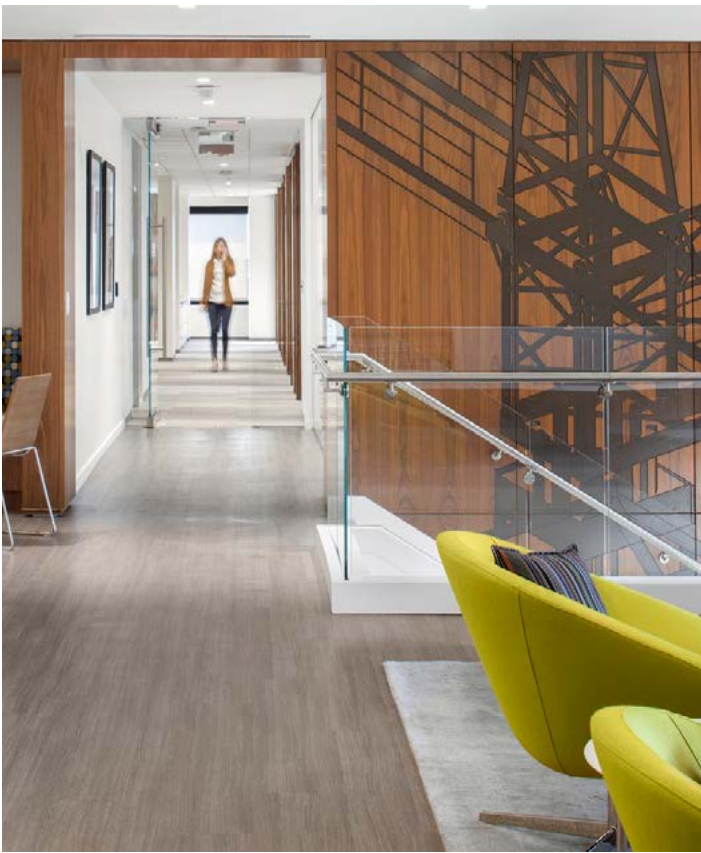

Watt Tieder, a global construction law practice, engaged IA for the relocation of their corporate office in McLean, VA. After a visioning session and focus groups with partners of the firm, project goals were established, including the need for spatial infrastructure for social and professional staff interactions, a functional and efficient footprint that redefines spatial hierarchy, bright and healthy spaces, and a timeless design. Weighing these goals, the IA design team provided test-fits for four different buildings that allowed the firm make the best selection.

The selected, new construction building offers an abundance of natural light, panoramic views, and room for future expansion. From the main reception, the 10th floor features a large, divisible conference room with a catering pantry, support spaces, and offices for the corporate accounting and IT departments. Leading to the 11th floor, the open staircase features a routed wood panel wall with a construction crane graphic perfectly aligned to the stair angle. At the top of the stairs, a cafe/attorney lounge becomes the heart of the space for gatherings, social interactions, collaboration, or "alone together" work.

As the practice floor, attorneys and support staff are all within effective proximity of each on the 11th floor. All partner offices are universally sized and glass-fronted with sit-stand desks and adjacent to shared, "corner office" team rooms. Two open administrative assistant stations, for every eight partner offices,

create light-filled team zones with collaborative tables, file and book storage, and a library setting with seating. Flexible case rooms are available to tackle a diverse range of assignments and double as team rooms with the appropriate mix of technology and furnishings.

While access to natural light and views make the space feel welcoming, it also plays a crucial role in occupant wellbeing by reinforcing the natural rhythm of work, intuitive wayfinding, and, consequently, productivity. Light is celebrated and strategically unblocked from windows at the corridor ends, team and community spaces, and office fronts. Careful coordination of mechanical systems and lighting allowed for high ceilings, further spreading the natural light into the building's core.

**"Beyond the fact that the project came in on time and budget, the design is very bright and creative and it has attracted many complements from our clients and guests. For our lawyers and staff who spend enormous hours in the office, there is universal pride in their new work home."**

LEWIS BAKER, SENIOR PARTNER | WATT, TIEDER, HOFFAR & FITZGERALD, LLP